

# TR Hank® Rivet Bushes

## Serrated Face Standoff (RF)

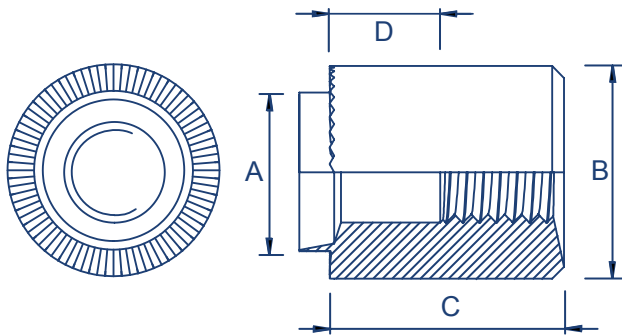

Steel/Zinc & Clear (TC1) | Steel/Self Finish (SF) | Stainless Steel/Self Finish (SF)



### Metric Dimensions

Thread form		M2.5	M3	M3.5	M4	M5	M6	M8	M10	M12
Diameter of spigot +0.00 -0.13mm	A	5.54	5.54	6.73	6.73	7.92	9.52	12.70	15.87	19.05
Diameter of body ±0.15mm	B	7.92	7.92	9.52	9.52	11.10	12.70	15.87	19.05	25.40
Recommended hole size +0.05 -0.00mm		5.54	5.54	6.73	6.73	7.92	9.52	12.70	15.87	19.05
Length of body ±0.13mm	C	To customer requirements								
Length of body ±0.13mm	C	8-10mm		11-13mm		14-16mm		14-22mm		
Depth of c/bore	D	3.0mm Nom		6.0mm Nom		9.0mm Nom		12.0mm Nom		

### Imperial/Unified Dimensions

Thread form	BSW/F	-	1/8"	-	5/32"	3/16"	1/4"	5/16"	3/8"	1/2"
	BA	8	6	4	3	2	0	-	-	-
	UNC	2	4	6	8	10	1/4"	5/16"	3/8"	1/2"
	UNF	2	4	6	8	10	1/4"	5/16"	3/8"	1/2"
Diameter of spigot +0.000 -0.005	A	.218	.218	.265	.265	.312	.375	.500	.625	.750
Diameter of body +0.010	B	.312	.312	.375	.375	.437	.500	.625	.750	1.000
Recommended hole size +0.05 -0.00mm		.218	.218	.265	.265	.312	.375	.500	.625	.750
Length of body ±0.005"	C	To customer requirements								
Length of body ±0.005"	C	8-10mm		11-13mm		14-16mm		14-22mm		
Depth of c/bore	D	3.0mm Nom		6.0mm Nom		9.0mm Nom		12.0mm Nom		

All Imperial/Unified sizes are non-preferred - please enquire for availability